

# Installation Instructions

2" Wood / 2" Faux Wood  
and 1" Mini Blinds  
(Aluminum or Vinyl)

Prior to proceeding, confirm Fashion Wand®  
Head Rail Clamp fits the head rail of your blind.

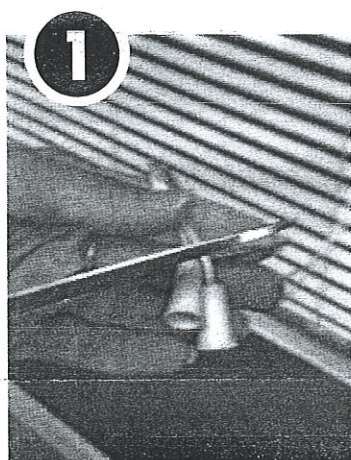
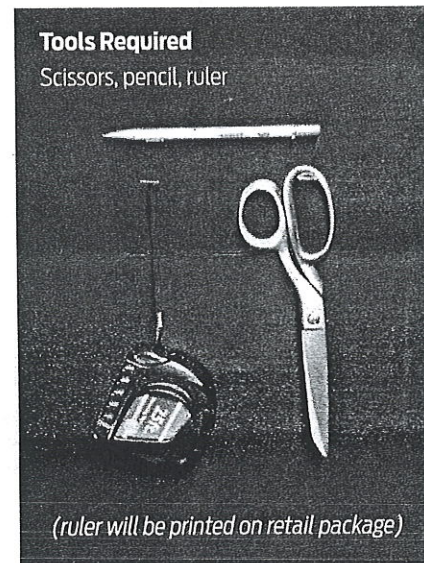
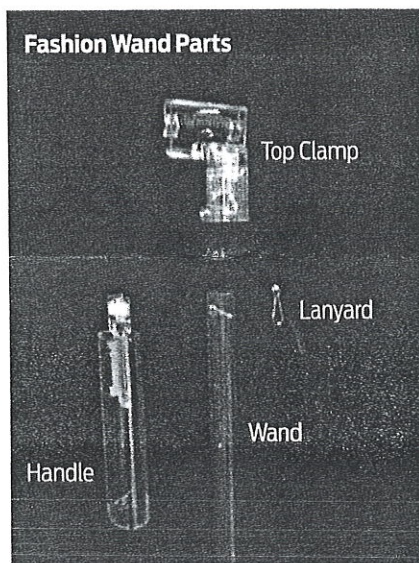

**1** With the blind in the down position, confirm fit of the Fashion Wand Head Rail clamp, then remove tassels with scissors and discard. Cut cord evenly, this will be your reference for keeping the blind level.

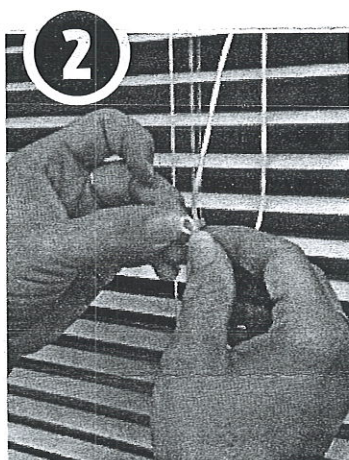

**2** Remove plastic stops and discard.

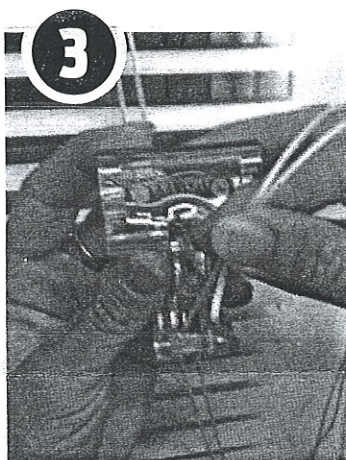

**3** Take top clamp and turn it around. Thread the pull cords over the pulley and out the bottom of the clamp.

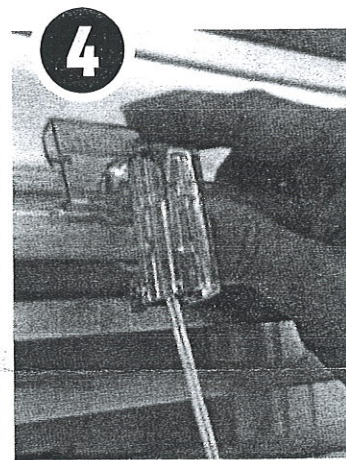

**4** Holding the pull cords, raise the clamp to the head rail, center clamp over cord lock, snap on.

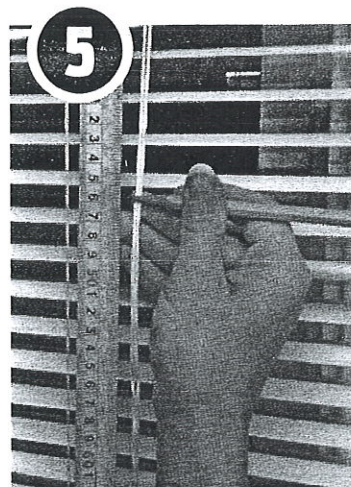

**5** With blind in the down position, measure from top of head rail down 14 inches, mark cords with a pencil.

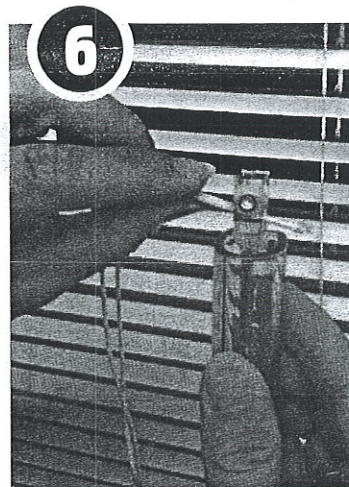

**6** Obtain handle and position D shape of handle towards you, thread cords (left to right) under pulley at top of handle.

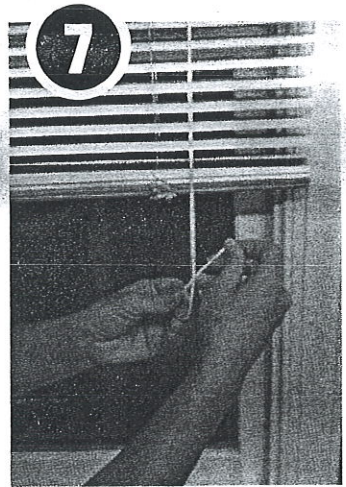

**7** Locate the marks you made on the cord. This is where you will tie a slip knot.

Loop cords at mark.

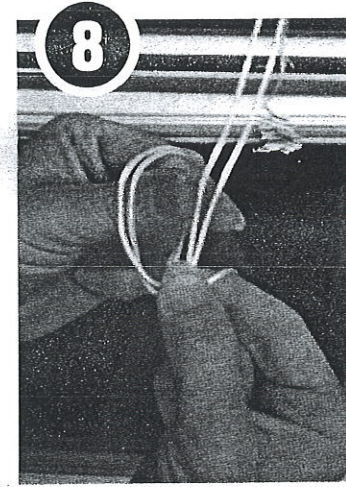

**8** Pull cord through loop.